

TECHNOLOGY • PRODUCTS • SERVICE...

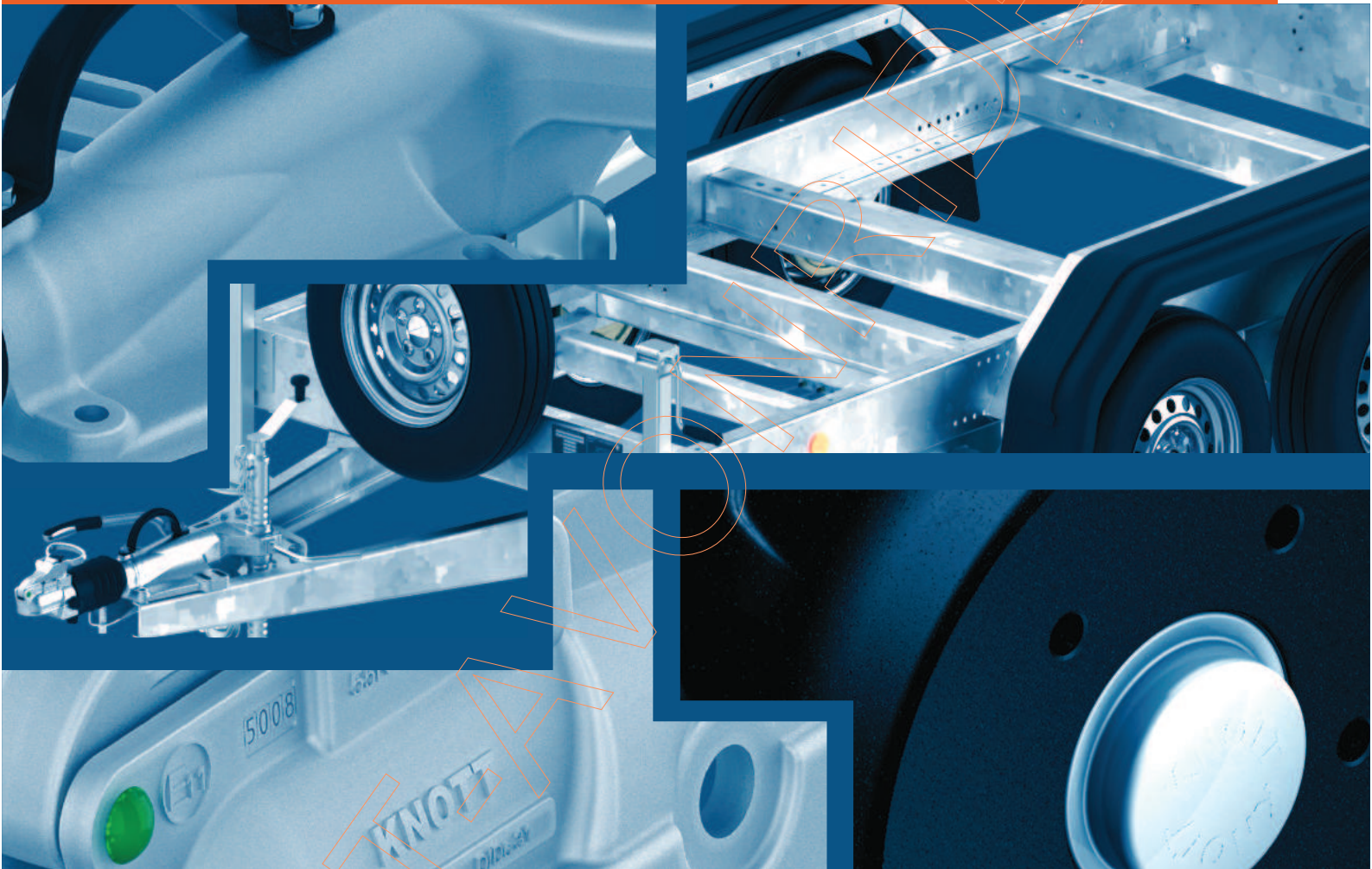

Trailer Components & Accessories

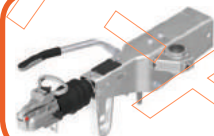

...THE COMPLETE PACKAGE!

Coupling
Assemblies 1Coupling Heads
& Eyes 2-3Coupling Spares
KFG13 - KFG35 4Coupling Spares
KF7,5 - KF27 5Coupling Spares
KRV7,5 - KRV35 6Coupling
Components 7Axles /
Suspension Unit 8-9

Brake Cables 10-11

Brake Cables /
Brake
Compensator 12Spreadlever
Auto Reverse
Brakes 13Spreadlever
Auto Adjusting
Brakes 14Drums &
Hubs 15-16Wheel Studs
Nuts & Bolts 17

Jockey Wheels 18



Mudguards 21



Winches 23

Security
Products 25Electrical Wiring
Connections 28EC Whole
Vehicle Type
Approval 31Towball Height /
Towing Jaws &
Hooks 33Propstands
& Brackets 19-20

Ancillaries 22

EU Approved
Drawbars 24Lamps &
Lighting 26-27Tyre Speed
Symbols &
Load Index 29-30Breakaway
Cables /
Secondary
Couplings 32

WWW.

Useful Contacts
& Publications 34

Always use **KNOTT** spares!

TECHNOLOGY • PRODUCTS • SERVICE...

COUPLINGS

AXLES, SUSPENSION UNITS & CABLES

KNOTT-AVONRIDE LIMITED

JOCKEY WHEELS, PROPSTANDS & BRACKETS

ANCILLARIES

...THE COMPLETE PACKAGE!

Company Profile

Knott-Avonride Ltd was established in the UK in 1983, for the manufacture and supply of brakes, couplings, brake cables and jockey wheels for trailers, caravans and off-road vehicles. Since then we have expanded our range of products and services to suit individual customer requirements.

We take pride in being reliable and friendly in day-to-day dealings: we know that it is important to develop good working relationships with our customers in order to discuss and develop their requirements.

The company is ISO 9001:2015 certified and committed to the introduction of new technology and techniques that will enable us to be more efficient, develop the product range, and address legislative requirements in Europe and Worldwide.

Quality Policy

It is the policy of Knott-Avonride Ltd to provide its customers with high quality products, complying with regulations, on time delivery, and ever improving levels of satisfaction. Knott-Avonride Ltd is committed to comply with the requirements of its QMS through the continual improvement of its products, services, and the company itself, by process control, employee involvement and management commitment.

If you have any thoughts, recommendations or suggestions as to how we can improve our products and services, please do not hesitate to contact us.



Cast Delta



Type	Capacity (kg)	Part Number *	Centres (mm)
KFG13	750 - 1300	KCB13AOD	100
KFG13	750 - 1300	KCB13AO120D	120
KFG20	1100 - 2000	KCB20AOD	100
KFG20	1100 - 2000	KCB20AO120D	120
KFG27	1400 - 2700	KCB27AOD	100
KFG27	1400 - 2700	KCB27AO120D	120
KFG30	1600 - 3000	KCB30AOD	100
KFG30	1600 - 3000	KCB30AO120D	120
KFG35	2700 - 3500	KCB35AOD	120

Pressed Steel Delta



Type	Capacity (kg)	Part Number *	Centres (mm)
KF13-A	375 - 750	KPB13AODA	110/120
KF13-C	750 - 1300	KPB13AOD	110/120
KF17	1100 - 1700	KPB17AOD	110/120
KF20	1100 - 2000	KPB20AOD	110/120
KF27	1400 - 2700	KPB27AO110/120D	110/120
KFGL35	2700 - 3500	204509.002	120/140

Pressed Steel Square Tube

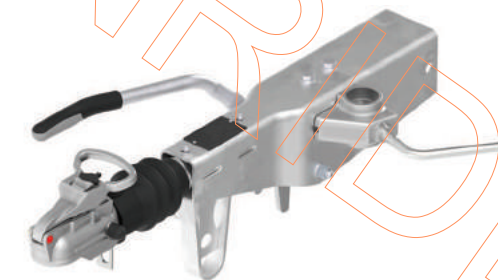

Type	Capacity (kg)	Part Number *	Size (mm)
KRV7,5	375 - 750	KSGB7AO6D	□ 60
KRV7,5	375 - 750	KSGB7AO7D	□ 70
KRV13	750 - 1300	KSGB13AO6D	□ 60
KRV13	750 - 1300	KSGB13AO7D	□ 70
KRV17	1100 - 1700	KSGB17AO7D	□ 70
KRV20	1100 - 2000	KSB20AO8D	□ 80
KRV20	1100 - 2000	KSB20AO10D	□ 100
KRV30	1600 - 3000	KSB30AO8D	□ 80
KRV30	1600 - 3000	KSB30AO10D	□ 100
KRV35	2700 - 3500	501084.007	□ 120

* Fitted with Avonride Cast Locking Head

All of these couplings can alternatively be supplied & fitted with :-

- ✓ Knott 50mm Head (Pressed Steel to 2T)
- ✓ Knott 50mm Head (Cast Lockable to 3,5T)
- ✓ Knott Group 50mm Head (Cast to 3,5T)
- ✓ 30mm UK BS Eye (to 3,5T)
- ✓ 40mm UK BS Eye (to 3,5T)
- ✓ 50.8mm UK BS Eye (to 3,5T)
- ✓ 76mm NATO Eye (to 3,5T)

APPROVED

EU / UNECE

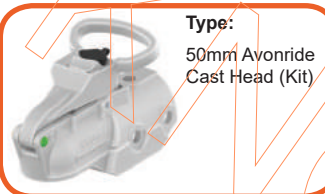

Type:
50mm Avonride
Cast Head (Kit)

Fitting:	Part Number:	Applications:
Ø45, M12/M12*	575003	KF13 - 20, KFG13 - 20 & KRV7,5 - 20
Ø50, M12/M12	575003	KF27A & KFG27
Ø50, M12/M14	575005	KFG30 & KRV30
Ø50, M14/M14	575008	KF27B, KFG30 & KRV30
Ø60, M14/M14	575004	KFG35 & KRV35



Type:
50mm Cast
Head (Kit)

Fitting:	Part Number:	Applications:
Ø50, M12/M12	575010	KF27B, KFG30 & KRV30
Ø50, M14/M14	575009	KF27A & KFG27
Ø60, M14/M14	575011	KFG35 & KRV35 Vertical / Horizontal Bolt Holes



Type:
30mm UK Eye
(Kit)

Fitting:	Part Number:	Applications:
Ø45, M12/M12	575030.001	KF13 - 20, KFG13 - 20 & KRV7,5 - 20
Ø50, M12/M12	575030.004	KF27A & KFG27
Ø50, M12/M14	575030.002	KFG30 & KRV30
Ø50, M14/M14	575030.005	KF27B, KFG30 & KRV30
Ø60, M14/M14	575030.003	KFG35 & KRV35



Type:
40mm UK Eye
(Kit)

Fitting:	Part Number:	Applications:
Ø45, M12/M12	575040.001	KF13 - 20, KFG13 - 20 & KRV7,5 - 20
Ø50, M12/M12	575040.004	KF27A & KFG27
Ø50, M12/M14	575040.002	KFG30 & KRV30
Ø50, M14/M14	575040.005	KF27B, KFG30 & KRV30
Ø60, M14/M14	575040.003	KFG35 & KRV35



Type:
50mm UK Eye
(Kit)

Fitting:	Part Number:	Applications:
Ø45, M12/M12	575050.001	KF13 - 20, KFG13 - 20 & KRV7,5 - 20
Ø50, M12/M12	575050.004	KF27A & KFG27
Ø50, M12/M14	575050.002	KFG30 & KRV30
Ø50, M14/M14	575050.005	KF27B, KFG30 & KRV30
Ø60, M14/M14	575050.003	KFG35 & KRV35



Type:
NATO Eye (Kit)

Fitting:	Part Number:	Applications:
Ø45, M12/M12	506005	KF13 - 20, KFG13 - 20 & KRV7,5 - 20
Ø50, M12/M12	506006	KF27A & KFG27
Ø50, M12/M14	506007	KFG30 & KRV30
Ø50, M14/M14	506014	KF27B, KFG30 & KRV30
Ø60, M14/M14	506008	KFG35 & KRV35

* With supplied adaptor



Type:
50mm Knott
Pressed Head
(Kit)

Fitting:	Part Number:	Applications:
Ø45, M12/M12 1400kg	575001	KF13, KRV7,5-13 & KFG13
Ø45, M12/M12 2000kg	575002	KF13 - 20, KRV20 & KFG20



Type:
50mm Knott
Cast Head
3000kg

Fitting:	Part Number:	Applications:
Ø35, M12/M12*	6E0350.101	Universal 3000kg Capacity Couplings
Ø40, M12/M12*		
Ø45, M12/M12*		
Ø50, M12/M12		
Ø50, M14/M14		



Type:
50mm Knott
Square
Pressed Steel
Head Unbraked
750kg

Fitting:	Part Number:	Applications:
□ 50, 2xM12 Vertical	KQ7KVL	750kg Unbraked
□ 60, 2xM12 Vertical	KQ7LVL	750kg Unbraked
□ 70, 2xM12 Vert/Horiz.	K75JN3	750kg Unbraked



Type:
50mm Knott
Square
Pressed Steel
Head Unbraked
1400kg

Fitting:	Part Number:	Applications:
□ 50, 4xM12 Vert/Horiz.	KQ14AVN2L	1400kg Unbraked*
□ 60, 4xM12 Vert/Horiz.	KQ14BHN2L	1400kg Unbraked*



Type:
50mm Knott
Round
Pressed Steel
Head Unbraked

Fitting:	Part Number:	Applications:
Ø60, 2xM12 Vertical	K14BN2L	750kg Unbraked
Ø70, 2xM12 Vertical	6E0083.033	750kg Unbraked



Type:
50mm Knott
Cast
Unbraked
Head
2700kg

Fitting:	Part Number:	Applications:
2xM12 Vertical	6E0286.001	2700kg Unbraked*

* With supplied adaptor

*For unbraked drawbars, unbraked trailers O1 Classification limited to 750kg gross mass.



68mm "French" & 40mm DIN eyes available.
Kits comprise Head or Eye, Bolts, Nuts, Shaped Washer(s) & Black Cap(s).

Always use **KNOTT** spares!

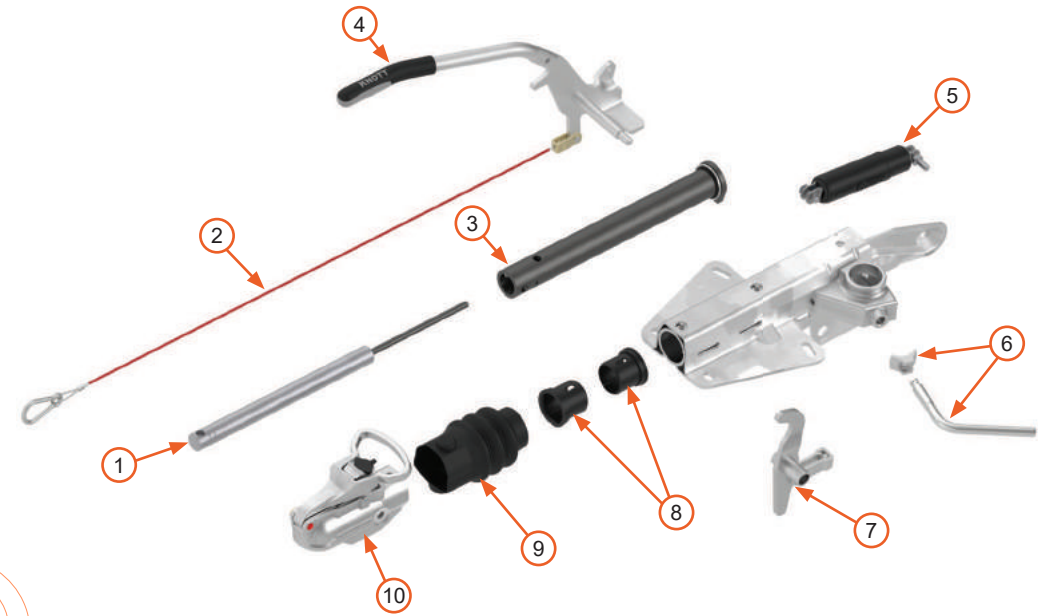
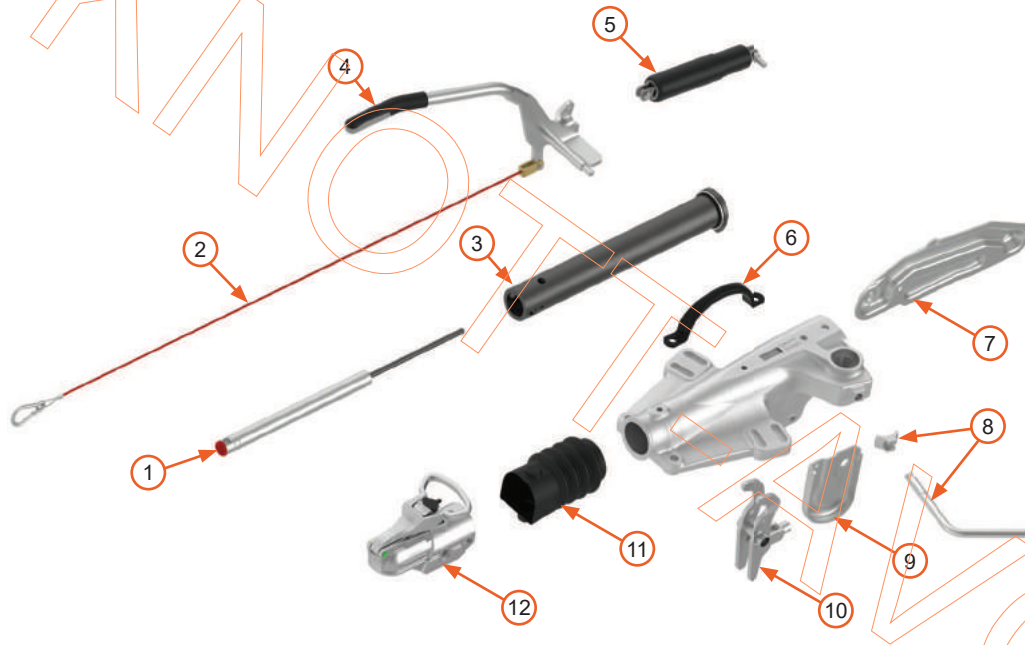

Description	To Suit	Part Number
1 Damper	KFG13	576000
	KFG20	576001
	KFG27(Ø12)	576002 (current as shown)
	KFG30(Ø12)	576006 (old)
	KFG30(Ø14)	576007 (current as shown)
2 Breakaway Cable	KFG35	576003
	Current Oil Damped Energy Store (1200mm long)	577017
3 Drawtube	KFG13 - 20	9810309402
	KFG27 (Ø12)	9810389402
	KFG30 (Ø14)	202041.002
	KFG30 (Ø12 & Ø14)	9885759302
	KFG35 (Cross Holes)	9870004402
4 Handbrake Assembly	KFG35 (Horiz. Holes)	203146.002
	Energy Store (as shown)	6J1389.001
	Spring Pack (old style spring pack)	6J1309.001
	All	202453.001 (as shown)
5 Energy Store	750-2000kg	98702594 (old)
	2700-3500kg	98702694 (old)

Description	To Suit	Part Number
6 Grab Handle	All	4300739302
7 Energy Store Bracket	All	206625.003 (as shown)
		34007083 (old style spring pack)
8 Jockey Pad	All	21004084
	Short	51002094
	Long	51002194
9 Handle	Xtra Long	510001PL
10 Bolt-on Skid	All	206593.001
11 Overrun Lever	KFG13-30	200406.001
	KFG35	98812993
	KFG13-30 (Eye)	577002
	KFG13-30 (head)	577004
	KFG35 (Head)	577005
12 Bellow	KFG35 (Eye)	577006
12 Head or Eye	See Pages 2-3	

Description	To Suit	Part Number
1 Damper	KF7,5 & KF13-A	576004
	KF13-C & E	576000
	KF20	576001
	KF27 (Ø12)	567002 (old)
	KF27 (Ø14)	576005 (current as shown)
2 Breakaway Cable	Current oil Damped Energy Store (1055mm Long)	577001
	Current oil Damped Energy Store (1200mm Long)	577017
3 Drawtube	KF7,5-20	9810309402
	KF27-A (Ø12)	9810389402
	KF27-B (Ø14)	202041.002
4 Handbrake Assembly	KF7,5-20 (current energy store as shown)	6J1349.001
	KF27 (current energy store as shown)	6J1595.003
	KF7,5-27 (old style spring pack)	6J1309.001

Description	To Suit	Part Number
5 Energy Store (current as shown)	All	201856.001
6 Spring Pack (old)	750 -2000kg	98702594
	2000kg-3500kg	98702694
7 Jockey Pad	All	21004084
8 Handle	Short	51002094
	Long	51002194
	Xtra Long	510001PL
9 Overrun Lever	KF7,5-20	98722483
	KF27	200406.001
10 Clip-in Bush (started Mid '09)	KF7,5-20 (Ø45mm)	577009
	KF27 (Ø50mm)	577010
11 Bellows	All (Black)	577002 (Black)
	All (Red)	577003 (Red)
12 Head or Eye	See Pages 2-3	

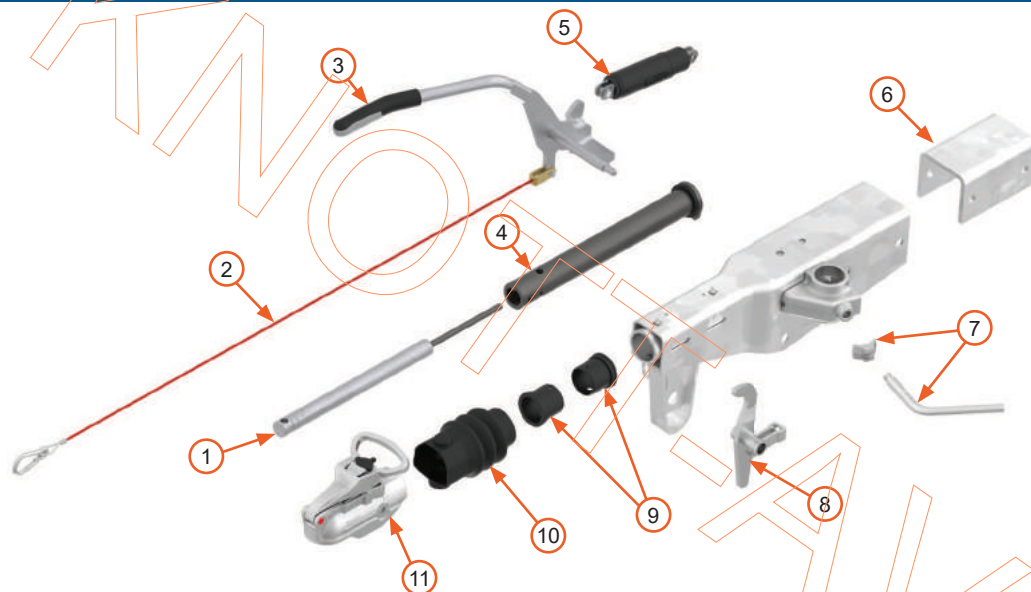

Description	To Suit	Part Number
1 Damper	KRV7,5	576004
	KRV13	576000
	KRV20	576001
	KRV30 (Ø12)	576006 (old)
	KRV30 (Ø14)	576007 (current as shown)
2 Breakaway Cable	KRV35	576003
	Current Energy Store (shown) 1055mm long	577001
3 Handbrake Assembly	Current Energy Store (shown) 1200mm long	577017
	KRV7,5 - 20 (60, 70 & 80 Sq)	6J1595.001 (current as shown)
		6J1339.001 (old)
	KRV7,5 - 17 (60, 70)	203575.004 (current as shown)
	KRV20 - 30 (100 Sq)	6J1595.002 (current as shown)
4 Drawtube		6J1339.001 (old)
	KRV35	204149.001
	KRV7,5 - 20	9810309402
	KRV30 (Ø12 & Ø14)	9885759302
	KRV30 (2 x Ø14)	202041.002
	KRV35 (2 x Ø14 H&V)	9870004402
	KRV35 (2 x Ø14 H only)	203146.002

Description	To Suit	Part Number
5 Handbrake Energy Store	KRV7,5 - 20	201856.001 (current as shown)
	KRV7,5 - 20	98702594 (old)
	KRV30	202453.001 (current as shown)
	KRV30	98702694 (old)
	KRV35	202453.001 (current as shown)
6 Mounting Packer	KRV7,5 - KRV17 70 down to 60	208186.001
	KRV20 - 20B1 80 down to 70	501151.001
	KRV20 - 30 100 down to 80	203643.001
	KRV20 - 30 100 down to 90	501150.001
	KRV35 120 down to 100	501159.001
7 Jockey Pad	All	21004084
	Short	51002094
	Long	51002194
8 Clamp Handle	Extra Long	510001PL
	KRV7,5 - 30	98722483
9 Overrun Lever	KRV35	98812993
10 Guide Bush	KRV7,5 - 20	504145.001
	KRV30	504150.001
11 Bellows	KRV7,5 - 30	577002
	KRV35	577006
11 Head or Eye	See Pages 2-3	

Overrun Dampers



Weight Range (kg)	Part Number (Marking)	Applications
375 - 750	576004 (8700309)	KRV7,5, KF7,5, KF13-A
750 - 1400	576000 (87000709)	KRV13, KFG13 & KF13-E & C
1100 - 2000	576001 (87001109)	KRV20, KFG20 & KF20
1400 - 2700	576002 (87003109)	KFG27 & KF27A with Ø12 Hole
1400 - 2700	576005 (8700310914)	KF27B with Ø14 Hole
1600 - 3000	576006 (87003909)	KRV30 & KFG30 with Ø12 Hole
1600 - 3000	576007 (87001409-K)	KRV30 & KFG30 with Ø14 Hole
2700 - 3500	576003 (87003609)	KFG35, KRV35 & KFGL35

Drawtubes



Fitting	Part Number	Applications
Ø45 M12/M12	9810309402	KF7,5 - KF20, KRV7,5 - 20, KFG13 & KFG20
Ø50 M12/M12	9810389402	KF27A & KFG27
Ø50 M12/M14	9885759302	KRV30 & KFG30
Ø50 M14/M14	202041.002	KF27B & KFG30
Ø60 M14/M14	9870004402	KFG35, KRV35 & KFGL35 (H & V Bolt Holes)
Ø60 M14/M14	203146.002	KFG35, KRV35 & KFGL35 Horizontal Holes

Bellows



Part Number	Applications
577002	KF7,5 - KF27 & KRV13 - 30 (Black)
577003	KF7,5 - KF27 & KRV13 - 30 (Red)
577004	KFG13 - KFG30
577005	KFG35, KRV35 & KFGL35 Heads Only
577006	KFG35, KRV35 & KFGL35 Eyes Only

Handbrake Energy Store



To Suit Type	Part Number	Capacity (kg)
Spring Pack Energy Store (metal casing)	98702594	750 - 2000
	98702694	2700 - 3500
Oil Damped Energy Store (as shown)	201856.001	KF7,5 - KF27 & KRV13 - 20
	202453.001	All KFG, KFGL35, KRV30 - 35

Breakaway Cables



To Suit Type	Part Number
Current Energy Store 1055mm Long (Clevis)	577001
Current Energy Store 1200mm Long (Clevis)	577017
Old Style Spring Pack (Split Ring)	577012

Data for Rubber Torsion Axle

Permissible Axle Load	750kg
------------------------------	-------

Axle Beam	Galvanised	Brake Type	Unbraked
------------------	------------	-------------------	----------



Data for Rubber Torsion Axle

Permissible Axle Load	1000kg - 1500kg
------------------------------	-----------------

Axle Beam	Galvanised	Brake Type	20-2425/1 (200x50)
------------------	------------	-------------------	--------------------



Data for Rubber Torsion Axle

Permissible Axle Load	1800kg
------------------------------	--------

Axle Beam	Galvanised	Brake Type	25-2025 (250x40)
------------------	------------	-------------------	------------------



Data for Rubber Torsion Units

Permissible Axle Load	350kg - 1550kg
------------------------------	----------------

Axle Beam	Galvanised	Brake Type	Unbraked or Braked
------------------	------------	-------------------	--------------------



Please contact us to discuss your individual requirements.

To enable us to assist you with your specific requirements in identifying the correct axle to meet your needs, please provide us with the following information:-

- Full Axle or Suspension Units.
- Braked or Unbraked.
- Load Capacity.
- Wheel offset (ET).
- (OHF) Hub Face to Hub Face dimension.
- (MBC) Distance between the Mounting Bracket Centres.
- (PCD) Pitch Circle Diameter of the Hub / Drum (Wheel Connection).
- A & H dimensions for Suspension Units

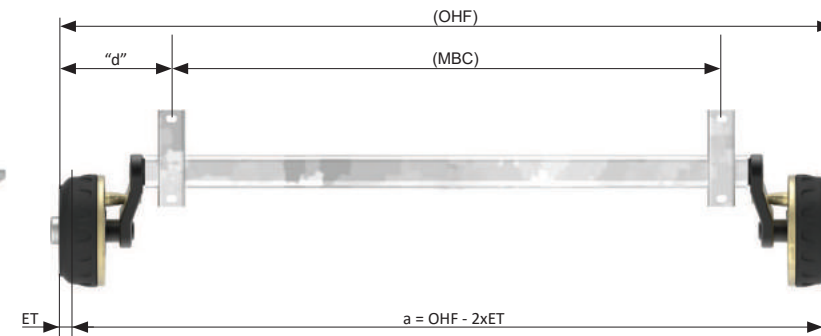

"d" minimum = 175mm • ET = Offset zero also available • For PCD options see Drums & Hubs pages 15 & 16

To identify the Pitch Circle Diameter (P.C.D) measure the distance between the centre of the hub to the centre of any stud or hole (as illustrated by the red line) then multiplying this dimension by two.

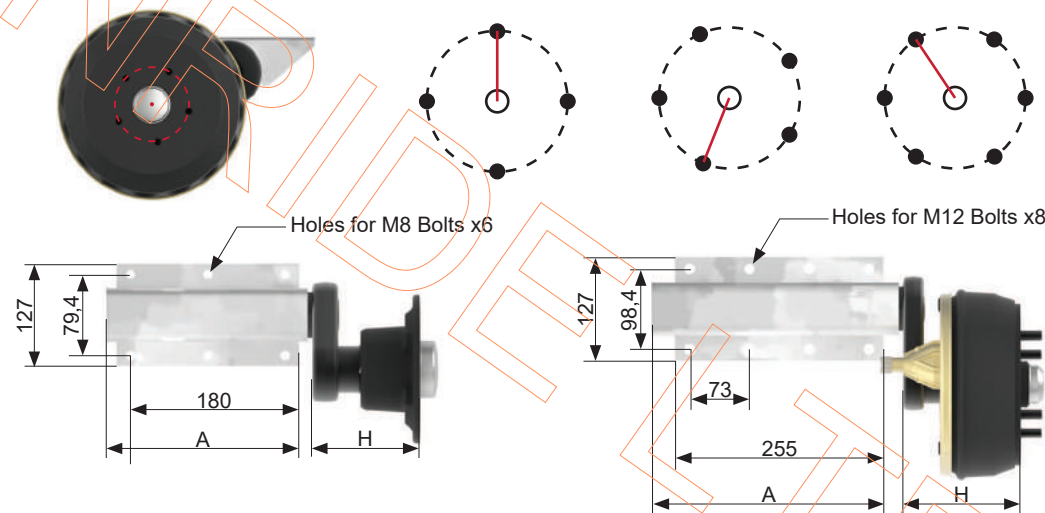

Matching fixing plates available!
C10939 (PLATE095) - 180x100mm (6 x M8 holes) C10940 (PLATE096) - 255x127mm (8 x M12 Holes)

Knott ETS System



The Knott Electronic Trailer Stabilisation (ETS) system is a retrofittable safety system for trailers / caravans (Class O2 up to 3500kg) with a mechanical overrun braking system, which can be used in conjunction with both single and tandem axles. It automatically detects critical oscillations and, if necessary, stabilises the vehicle-trailer combination through targeted brake intervention on the trailer.

Knott Stabilising Coupling Head

The Knott stabilising coupling head dampens any oscillations of the trailer. Improves stability of caravan / trailer during towing. Includes an engagement indicator to visually check the caravan / trailer is correctly coupled to the tow vehicle. Wear indicator to allow quick and easy checking of the condition of the friction elements.



Rocker Arm Suspension Axles

Unbraked and Braked versions available. Rated from 1350kg to 1800kg.



Power Brakes

Customised solutions for a wide range of applications. Disc brakes, CAM brakes and drum brakes available.

Adjustable Height Drawbars

1300kg to 3500kg capacities available. Manual (KHA) and winding (KHD as shown) versions available.



EC Type Approved Chassis

Knott-Avonride fully approved, complete rolling chassis ready for use. Generic customised or bespoke frames. Check out the Knott Chassis catalogue for a selection of our available options. Or Contact us to discuss your specific individual requirements.

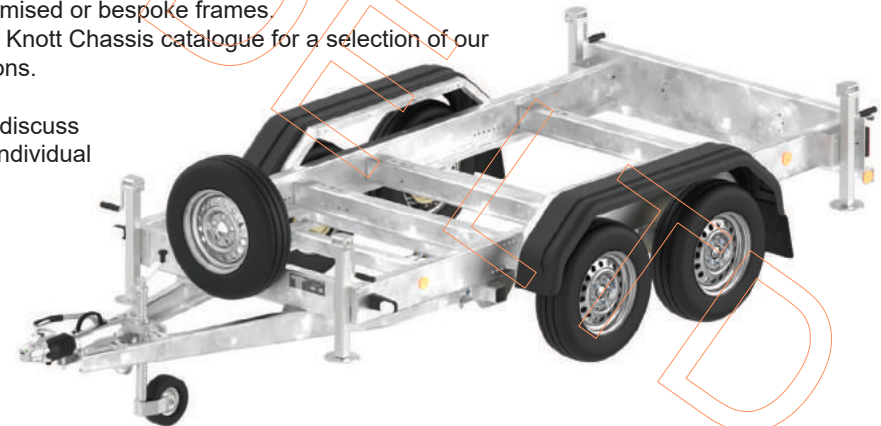

Knott Detachable - Ø3.5mm Ø18mm Bell

Standard (Black outer)

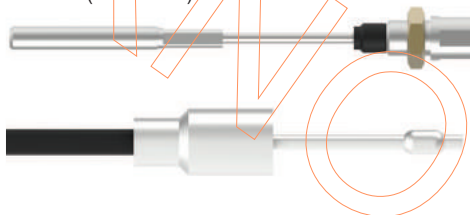

Stainless (Blue outer)



Length (mm)		Part Number	
Outer	Inner	Detachable Standard	Detachable Stainless Steel
630	840	33921.1.03	37086.03
730	940	33921.1.06	37086.06
830	1040	33921.1.07	37086.07
930	1140	33921.1.09	37086.09
1030	1240	33921.1.11	37086.11
1130	1340	33921.1.13	37086.13
1230	1440	33921.1.14	37086.14
1330	1540	33921.1.15	37086.15
1430	1640	33921.1.16	37086.16
1530	1740	33921.1.17	37086.17
1630	1840	33921.1.18	37086.18
1730	1940	33921.1.25	37086.25
1830	2040	33921.1.23	37086.23
1930	2140	33921.1.35	37086.35
2030	2240	33921.1.24	37086.24
2130	2340	33921.1.32	37086.32

Knott Detachable - c/w Clevis Ø18mm Bell



Length (mm)		Part Number	
Outer	Inner	Standard	Stainless Steel
650	890	35902.01	980153.01
1086	1326	35902.02	980153.02
1240	1480	35902.03	980153.03
1600	1840	35902.04	980153.04
1030	1240	35902.05	980153.05

Non Detachable



Length (mm)		Part Number
Outer	Inner	
600	875	35006.04
700	1000	35006.06
800	1100	35006.10
900	1200	35006.14
1000	1300	35006.16
1100	1400	35006.20
1200	1500	35006.24
1300	1575	35006.32
1400	1700	35006.28
1500	1800	35006.30
1600	1900	35006.33
1700	2000	35006.37



Other sizes & bespoke cables available on request

Knott Pronto Fit - Ø3.5mm Ø18mm Bell

Standard (Black outer)



Stainless (Blue outer)



Length (mm)		Part Number	
Outer	Inner	Detachable Standard	Detachable Stainless Steel
430	620	980202.01	980207.01
530	720	980202.02	980207.02
630	820	980202.03	980207.03
730	920	980202.06	980207.06
830	1020	980202.07	980207.07
930	1120	980202.09	980207.09
1030	1220	980202.11	980207.11
1130	1320	980202.13	980207.13
1230	1420	980202.14	980207.14
1330	1520	980202.15	980207.15
1430	1620	980202.16	980207.16
1530	1720	980202.17	980207.17
1630	1820	980202.18	980207.18
1730	1920	980202.25	980207.25

Knott Detachable - Ø3.5mm Ø23.5mm Bell



Length (mm)		Part Number
Outer	Inner	
350	560	35122.01
530	740	35122.02
770	980	35122.03
890	1100	35122.04
1020	1230	35122.05
1130	1340	35122.06
1320	1530	35122.07
1430	1640	35122.08
1620	1830	35122.09
1790	2000	35122.10
1920	2200	35122.11

Knott Pronto Fit - Ø3.5mm Ø23.5mm Bell

Standard (Black outer)

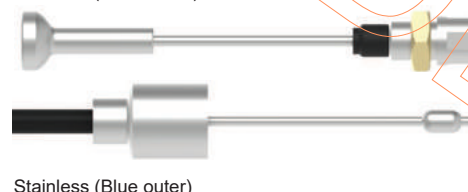

Stainless (Blue outer)



Length (mm)		Part Number	
Outer	Inner	Detachable Standard	Detachable Stainless Steel
520	726	980203.01	980206.01
770	966	980203.02	980206.02
890	1086	980203.03	980206.03
1020	1216	980203.04	980206.04
1130	1326	980203.05	980206.05
1320	1516	980203.06	980206.06
1430	1626	980203.07	980206.07
1620	1816	980203.08	980206.08
1790	1986	980203.09	980206.09

Detachable Ø5mm Ø25.5mm Bell



Length (mm) Outer	Length (mm) Inner	Part Number
500	760	33983.1.01
700	960	33983.1.02
800	1060	33983.1.03
900	1160	33983.1.04
1000	1260	33983.1.06
1100	1360	33983.1.07
1200	1460	33983.1.08
1300	1560	33983.1.09
1400	1660	33983.1.10

Special Ø5mm M10 Threads



Length (mm) Outer	Length (mm) Inner	Part Number
410	710	545000.136
500	800	545000.120
640	940	545000.174
900	1200	545000.012
950	1250	545000.030
1000	1300	545000.103
1180	1480	545000.114
1240	1540	545000.101
1500	1800	545000.160

Brake Compensator



Description	Comprising	Part Number
Pronto-Fit Single Axle Compensator Kit (Knott 55 Centres)	Balance Bar & Fasteners	572013
Pronto-Fit Tandem Axle Compensator Kit (Knott 55 Centres)	Equaliser Bar, Balance Bar (x2) & Fasteners	572012
Single Axle Compensator Kit (Avonride 65 Centres)	Balance Bar & Fasteners	572001
Tandem Axle Compensator Kit (Avonride 65 Centres)	Equaliser Bar & Fasteners	572002

Current Knott Group Balance Bar

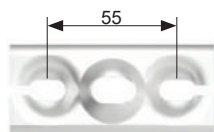

For use with threaded & pronto fit cables.

Old Avonride Balance Bar

(No longer used on current production) since 2010

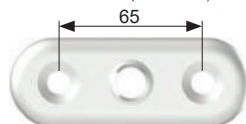

For use with threaded cables only.



The KNOTT Group is represented in every EU country and beyond. This assures users that support is readily available locally no matter where the trailer is used.



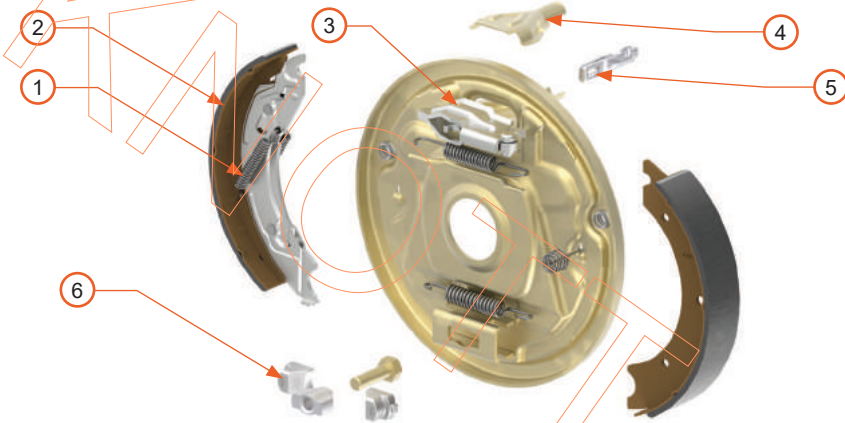

Description	To Suit	Part Number
1 Spring Kits Axle Set (Auto Reverse) Includes Carrier tension springs, Shoe Steady Spring & Buckle (not shown)	160x35 Mk.III	520076
	200x50	520077
	203x40	520049
	250x40	520050
	250x50	520208
	300x60	520078

Description	To Suit	Part Number
2 Brake Shoe Axle Set (Auto Reverse) Inc. 2 x Fixed Shoes, 2 x Sliding Shoes & Spring Set	160x35 Mk.III	520064.001
	200x50	520066.004
	203x40	520065.003
	250x40	520067.004
	250x50	520207.001
	300x60	520089.004

Description	To Suit	Part Number
3 Expander	160x35 Mk.III	406415.001
	200x50, 203x40, 250x40 & 250x50	45309
	300x60	43123-1

Description	To Suit	Part Number
4 Half Shell	160x35, 200x50, 203x40, 250x40 & 250x50	572000 (qty. 2)
	300x60	33623

Description	To Suit	Part Number
5 Eyelet	160x35, 200x50, 203x40, 250x40	572014 (qty. 2)
	250x50	45207
	300x60	33623

Description	To Suit	Part Number
6 Adjuster Kit Inc. Wedge, Bolt & Shoe Posts	160x35, 200x50, 203x40	572007
	250x40, 250x50	572008
	300x60	572016

Vehicle "UP" Time Increased

Service Intervals Extended

Servicing Time Reduced



We have developed and Type Approved a trailer brake that automatically adjusts, ensuring that the brakes are always at their optimal setting. This means:-

- ✓ Quick and simple installation.
- ✓ With UNECE Regulation 13 Approval.
- ✓ Braking response is always immediate, equal and smooth on all wheels.
- ✓ Braking distance is reduced to its shortest.
- ✓ Reversing is trouble free.
- ✓ Handbrake application and release is effortless.
- ✓ Reduced wear and tear on trailer, damper, cables, rods, linkages.
- ✓ Reduced wear and tear on towing vehicle.
- ✓ Road-worthiness is maintained = peace of mind for the fleet operator.
- ✓ Servicing is quicker, emphasis on brake inspection, not brake adjustment.
- ✓ Trailer Brake related accidents and incidents are avoided.
- ✓ Health and Safety improved.

For 200x50 with auto reverse

Description	Weight (kg)	Part Number
Axle Set - 200x50 Auto Adjusting Brake for KNOTT Brake Types 20-2425/1	3,30	409930.001*

* Suitable for use on all 200x50 brake assemblies



For 250x40 with auto reverse

Description	Weight (kg)	Part Number
Axle Set - 250x40 Auto Adjusting Brake for KNOTT Brake Types 25-2025	4,70	409931.001



Only backplates with this form can be retro-fitted with Auto-adjust.

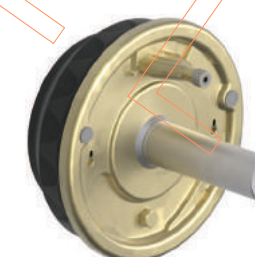

Backplates with this form cannot be retro-fitted.

Braked 160x35

KNOTT
TPR BEARINGKNOTT
SFL BEARINGAVONRIDE
C SERIES

Brake Size / Type	Casting Number	Description	Kit Prefix	Bearing	Bearing Kit Inc. Seal	Grease Cap	Hub Nut
160x35 / 16-1365	23815	Knott TRB	5201xx	30204A 30206A	571012	42191 (48mm)	574008 (M20)
160x35 / 16-1365	24725 414039 6A2151	Knott SFL	409699	Ø34 x Ø64x 37mm	571005	573004 (64mm)	574014 (M24)
160x35 / 16-1365	12345	Avonride "C" Series	C24001	NTN 32004X L44649/L44610	571001	573002 (47mm)	574008 (M20)

Braked 200x50 / 203x40

KNOTT
TPR BEARINGKNOTT & AVONRIDE
SFL X SERIESKNOTT SFL
BEARING HDAVONRIDE
A SERIESAVONRIDE
R SERIES

Brake Size / Type	Casting Number	Description	Kit Prefix	Bearing	Bearing Kit Inc. Seal	Grease Cap	Hub Nut
200x50 / 20-2425	21240-2	Knott TRB	52012x	30205A 30206A	n/a	573005 (52mm)	574006 (M24)
200x50 / 20-2425	26979	Knott SFL	C24014	Ø34 x Ø64 x 37mm	571005	573004 (64mm)	574014 (M24)
200x50 / 20-2425	25955	Knott SFL HD	28744	Ø39 x Ø72 x 37mm	571006	573005 (52mm)	574014 (M24)
200x50 / 20-2425 203x40 / 20,32-1647	11890	Avonride "A" Series	C24000	NTN 32004X LM67048/LM67010	571002	573002 (47mm)	574008 (M20)
200x50 / 20-2425 203x40 / 20,32-1647	13856	Avonride "R" Series	C24011	L44649/L44610 LM67048/LM67010	571004	573001 (52.4mm)	574008 (M20)
200x50 / 20-2425 203x40 / 20,32-1647	26979	Avonride "X" Series	C24014	Ø34 x Ø64 x 37mm	571005	573004 (64mm)	574014 (M24)



- ✓ Studs or Tapped Holes?
 - ✓ Conical or Spherical Fixings?
- Please Specify

Braked 250x40

KNOTT & AVONRIDE
SFL Y SERIESAVONRIDE
T SERIESAVONRIDE
V SERIES

Brake Size / Type	Casting Number	Description	Kit Prefix	Bearing	Bearing Kit Inc. Seal	Grease Cap	Hub Nut
250x40 / 25-2025	25449	Knott SFL	C24015	Ø39 x Ø72 x Ø37mm	571006	573005 (52mm)	574014 (M24)
250x40 / 25-2025	14475	Avonride "T" Series	C24012	LM67048/LM67010 LM48548/LM48510	571000	573003 (74.5mm)	574006 (M24)
250x40 / 25-2025	14368	Avonride "V" Series	C24013	LM67048/LM67010 LM48548/LM48510	571000	573003 (74.5mm)	574006 (M24)
250x40 / 25-2025	25449	Avonride "Y" Series	C24015	Ø39 x Ø72 x 37mm	571006	573005 (52mm)	574014 (M24)

Unbraked

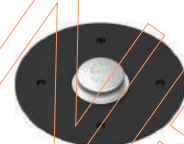
AVONRIDE & KNOTT
P SERIES SFL BEARINGKNOTT
TPR BEARINGAVONRIDE
E SERIESAVONRIDE
N SERIES

Brake Size / Type	Casting Number	Description	Kit Prefix	Bearing	Bearing Kit Inc. Seal	Grease Cap	Hub Nut
Unbraked	4H2145 6A2145	Knott SFL	C24010	Ø34 x Ø64 x 37mm	571005	573002 (47mm)	574014 (M24)
Unbraked	4H1229 6B1229	Knott TPR	52013x	30204A 30206A	571012	573002 (47mm)	6X0935.015 (M18)
Unbraked	12716	Avonride "E" Series	C24002	NTN 32004X L44649/L44610	571001	573002 (47mm)	574008 (M20)
Unbraked	15106	Avonride "N" Series	C24009	L44643/L44610 L44643/L44610	571003	573006 (50mm)	574008 (5/8 UNF)
Unbraked	6A2145	Avonride "P" Series	C24010	Ø34 x Ø64 x 37mm	571005	573002 (47mm)	574014 (M24)



PCD Options:-

- ✓ 4/98.0
- ✓ 4/100
- ✓ 4/101.6
- ✓ 4/139.7
- ✓ 5/112
- ✓ 5/140
- ✓ 5/165.1
- ✓ 5/152.4
- ✓ 6/205

TPR = Taper Roller / SFL = Sealed For Life

Wheel Studs



Hub	Type	Thread	T	Spline (length & Diameter)	Part Number
Avonride A / C / E Series	Stud	3/8 UNF	24mm	10mm / Ø10,4mm	574002
Avonride A / R / T / V / Y / E Series	Stud	M12 x 1,5	28mm	10,7mm / Ø14,6mm	574003
Avonride A / R / T / V / Y / E Series	Stud	M16 x 1,5	34mm	11,5mm / Ø16,7mm	574021

Wheel Bolts

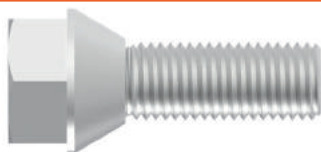

Size	Seating	Thread Length	Part Number
M12 x 1,5	Spherical	24mm	574016
M12 x 1,5	Conical	24mm	574015
M14 x 1,5	Spherical	24mm	574022

Wheel Nuts



Size	Seating	Part Number
3/8 UNF	Spherical	574000
M12	Spherical	574001
M14	Spherical	574023
M16	Spherical	574011
3/8 UNF	Conical	574024
M12	Conical	574004
M16	Conical	574010

Wheel Studs, Bolts & Nuts in Packs of 5 unless otherwise stated.

Conical / Tapered Seating

Spherical / Radius Seating

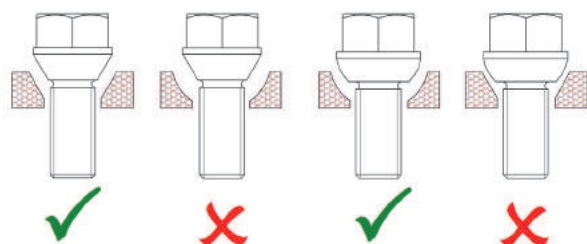

Wheel Nut Indicators



Description	Part Number
Checkpoint Indicator 17mm A/F (Pack of 10)	574018
Checkpoint Indicator 19mm A/F (Pack of 10)	574019
Checkpoint Indicator 27mm A/F (Pack of 10)	574020

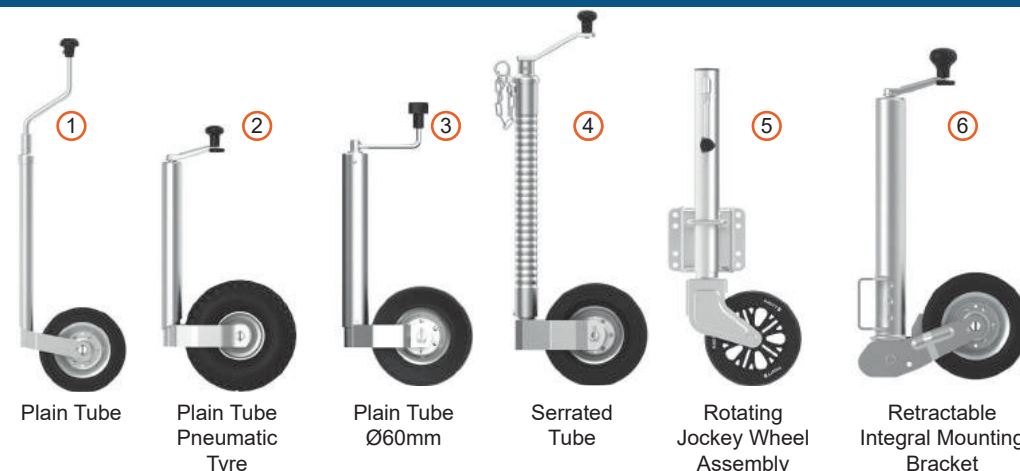

Plain Tube Jockey Wheels

Diameter	Tyre	Height w/o handle (mm) + extension	Part Number
Ø35	200 x 40	546 - 765	J135K
Ø42	200 x 40	600 - 825	J142K
Ø48	200 x 40	525 - 720	J148
Ø48	200 x 40	592 - 800	J148K
Ø48	205 x 50	710 - 930	J348P205
Ø48	260 x 85	400 - 580	J248PT
Ø60	225 x 65	410 - 615	408441.001

Serrated Tube Jockey Wheels

Diameter	Tyre	Height w/o handle (mm) + extension	Part Number
Ø48	205 x 50	710 - 930	J348S205
Ø48	230 x 65	720 - 940	J348S
Ø60	280 x 66	865 - 1150	J360B

Integral Mounting Bracket

Diameter	Tyre	Height w/o handle (mm) + extension	Part Number
Ø57	210 x 70	570 - 880	6D7706.001
Ø60	205 x 50	850 - 1115	J360R

Spares

Diameter	Rim / Tyre	Wheel Part No.	Part Number
200 x 40	Steel / Solid Rubber	200 / 40B	578004
205 x 50	Steel / Solid Rubber	205 / 50	578004
220 x 70	Steel / Solid Rubber	230 / 65	587005
260 x 85	Steel / Pneumatic	260 / 85	578006
280 x 66	Steel / Solid Rubber	280 / 66	578007

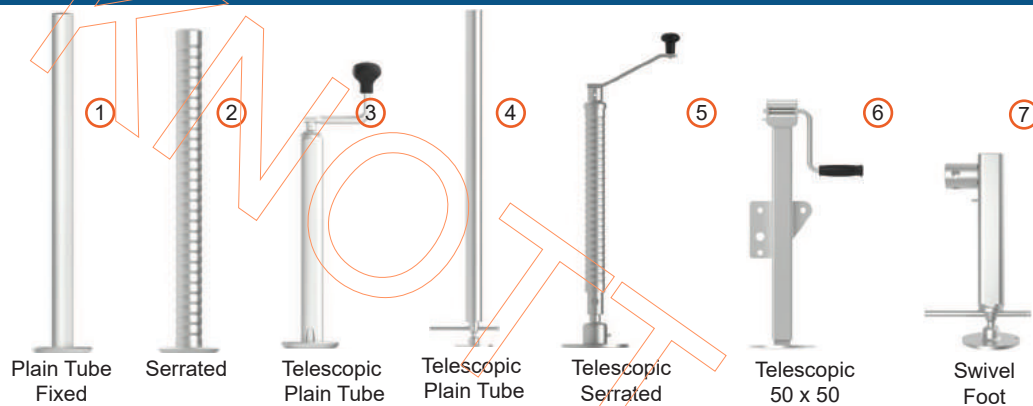

Plain Tube Fixed Propstands

Diameter	Length (mm)	Part Number
Ø35	450	P345PL
Ø35	600	P346PL
Ø42	600	P426PL
Ø42	750	P428PL
Ø48	600	P486PL
Ø48	750	P488PL
Ø48	900	P489PL

Serrated Tube Propstands

Diameter	Length (mm)	Part Number
Ø48	385	P48S385
Ø48	510	P48S508
Ø48	585	P48S585
Ø48	720	P48S720

Telescopic Tube Propstands

Diameter	Height w/o handle (mm) + extension	Part Number
Ø42 Plain Tube	402 - 617	TP42
Ø48 Plain Tube	406 - 646	TP48
Ø48 Plain Tube	600 - 900	3TTL100
Ø48 Plain Tube	983 - 1103	3TL040
Ø48 Serrated	547 - 800	3TTL060
50x50	575 - 907	6D6835.001 (LH)
50x50	575 - 907	6D6835.002 (RH)

Swivel Foot Propstand

Length (mm)	Part Number
500 Requires Mounting Bracket	PSF500
550 Requires Mounting Bracket	PSF550
Mounting Bracket to suit	BPSF



Cast Brackets



Diameter (mm)	Style	Mounting Hole Centres (mm)	Part Number
35	Cast	101 x Ø14.5 (x2)	B35C3
42	Cast	101 x Ø14.5 (x2)	B42C3
48	Cast	150 x Ø14.5 (x2)	B48C6

Pressed Steel Brackets

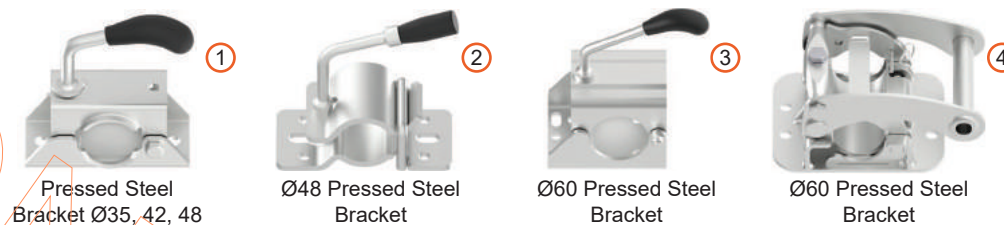

Diameter (mm)	Style	Mounting Hole Centres (mm)	Part Number
35	Pressed	105 x Ø11(x2)	B35P3
42	Pressed	105 x Ø11(x2)	B42P3
48	Pressed	105 x Ø11(x2)	B48P3
48	Pressed	112/120 x 50 x Ø11(x2)	3LB022
60	Pressed	105 x 40 x Ø11 (x4) / 70 x 50 x Ø11 (x4)	4802879X
60	Pressed	171 x 50 x Ø14.5(x4)	B60P

Pressed / Cast Steel Brackets

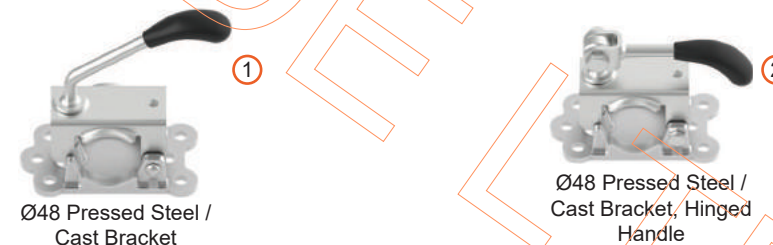

Diameter (mm)	Style	Mounting Hole Centres (mm)	Part Number
48	Pressed / Cast	105 x Ø11(x6)	4802869X
48	Pressed / Cast	105 x Ø11(x6)	403009.001

Polymer Single / Tandem

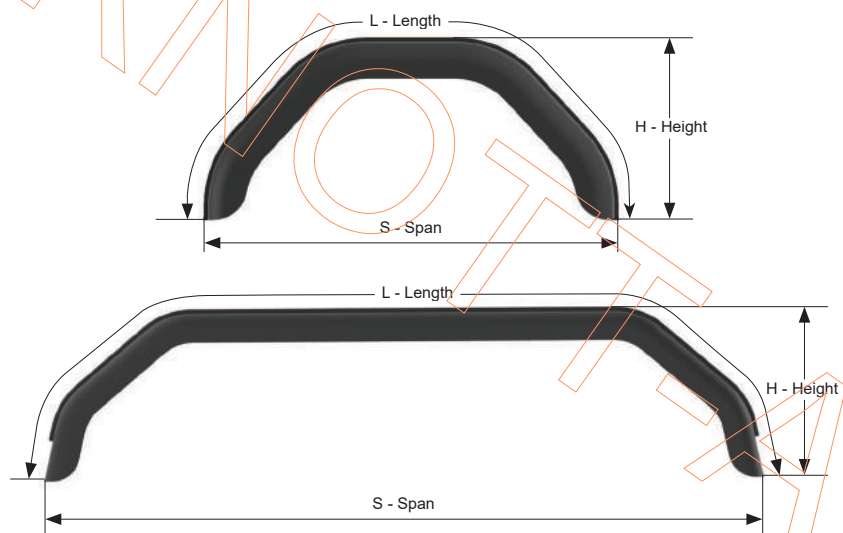

Tyre Size	Profile	Width 'W'	Length 'L'	Span 'S'	Height 'H'	Part Number
8"	10/40	145	730	500	195	531000.001
8"	12/40	120	770	520	230	404449.001
10"	10/40	180	885	610	250	531000.002
10"	12/40	180	1040	660	330	404450.001
12"	12/40	200	1040	660	330	404451.001
13"	12/40	220	1120	750	330	404452.001
13"	10/40	220	1165	770	340	531000.003
13"	12/40	220	1200	750	390	400340.001
14"	12/40	260	1300	800	415	400342.001
14"	12/40	220	1300	800	415	400341.001
14"	12/40	240	1300	800	415	4804279X
14"***	12/40	220	1970	1550	380	4804299X

** Tandem



- ✓ Available for single & tandem axle applications
- ✓ Vast range to suit majority of trailer wheel sizes
- ✓ Variable mounting profiles
- ✓ Separate mounting brackets available
- ✓ Half mudguard / wheel flap available



Other sizes available on request!

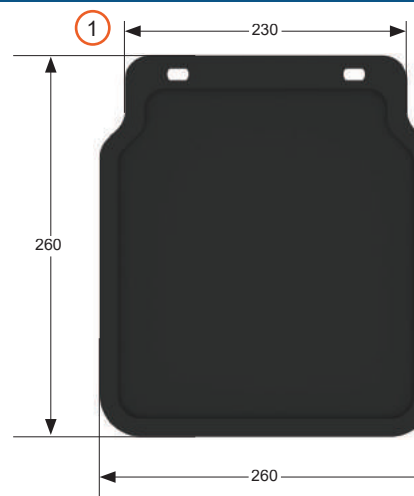

2



3



4



5

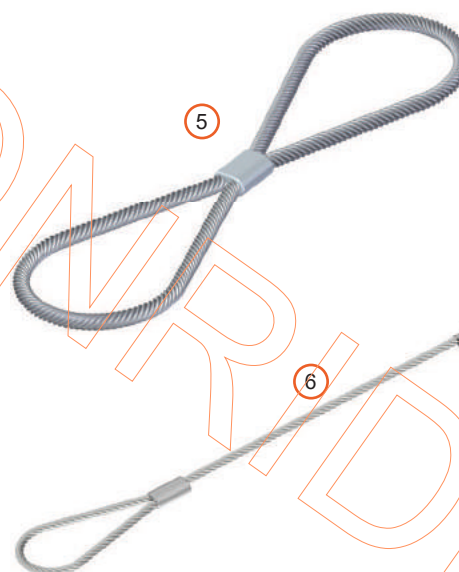

6

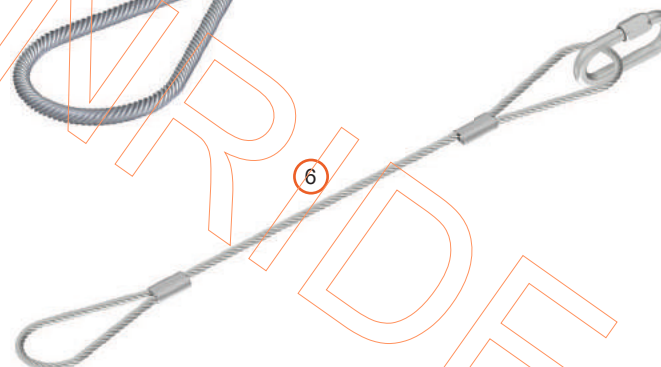

	Description	Part Number
1	Mud Flap (other sizes available upon request)	400086.011
2	Customised Chassis VIN Plate (blank available on request)	530307.001
3	7 Pin Plug Holder	407982.001
4	Wheel Chock 220 x 100 x 90 & Holder (1600kg)	570008 (White)
	Wheel Chock 220 x 100 x 90 & Holder (1600kg)	570010 (Black)
5	Secondary Coupling	577007
6	Secondary Coupling & Quick Link	506030.001



	Description	Part Number
EC Approved Winches	450kg Capacity*	6X0017.004
	900kg Capacity *	6X0017.005
	1100kg Capacity*	6X0017.006
Covers	For 6X0017.004	6X1238.001
	For 6X0017.005 & 006	6X1238.002
Cables	Ø4mm (7m long) For 6X0017.004	6X1522.001
	Ø5mm (10.1m long) For 6X0017.005	6X1522.002
	Ø5.3mm (10.1m long) For 6X0017.006	6X1522.003
Straps	48mm (9.8m long) For 6X0017.004 / 005	6X1407.001
	52mm (9.8m long) For 6X0017.006	6X1407.002

* Cable / Strap supplied separately.

A-Frame Drawbars

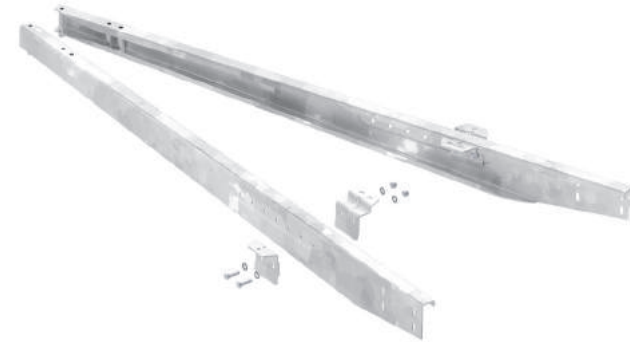

Type	Length (mm)	Description	Drawing Number*	Max. Weight (kg)
ZHL7,5-A	2000-2500	Bolt-On A-Frame	206061	750
ZHL15-A	2000-2500	Bolt-On A-Frame	201022	1800
ZHL20-A	2000-2500	Bolt-On A-Frame	201024	2400
ZHL-27A	2000-2500	Bolt-On A-Frame	201026	3000
ZHL35-A	2000-2500	Bolt-On A-Frame	201028	3500
C32000		Connector Kit 66mm Square Axle		
C32001		Connector Kit 77mm Square Axle		
402777.001		Connector Kit 80mm Round Axle		
29531.01		Connector Kit 80mm Square Axle		

* Drawing available on request

Square Drawbars (KDV)

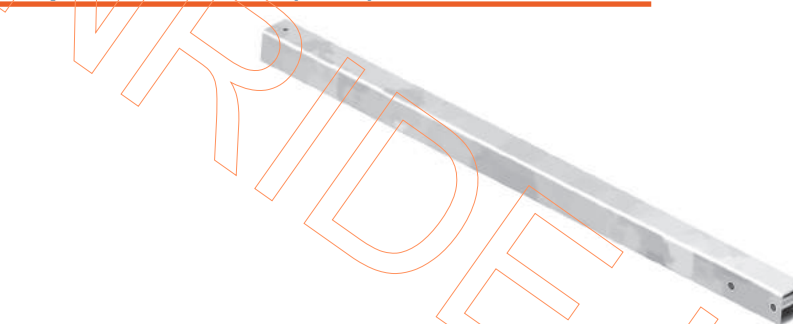

Type	Length (mm)	Description	Drawing Number*	Max. Weight (kg)
KDV60	1500-2500	60mm Straight	204602	1000
KDV70	1500-2500	70mm Straight	204603	1400
KDV80	1500-2500	80mm Straight	204791	2000
KDV100	1500-2500	100mm Straight	204605	3000
KDV120	1500-2500	120mm Straight	204606	3500

* Drawing available on request



Please contact us to discuss your individual requirements

Datatag is world renowned for its electronic theft deterrent systems. Its products have helped to drastically reduce rates of stolen property and are fitted on many assets such as motorcycles, jet skis, golf equipment and marine components.



Benefits include:-

- ✓ Peace of mind and security to any trailer application / caravan fitted with the kit.
- ✓ Proven deterrent against theft. The UK Crown Prosecution Service has a 100% successful prosecution record where Datatag has been used as evidence in court.
- ✓ Powerful aid to identification and recovery supported by a 24/7/365 Home Office and ACPO approved call centre.

Trailer Kit

- 2 x Highly Visible Trailer ID Plates
- 2 x Button Transponders
- 1 x Glass Transponder
- 1 x Tube of Datadots with Forensic DNA
- 1 x Epoxy Resin and Applicator
- 1 x Multi-Lingual Fitting Instructions
- 1 x Datatag Registration Form



Part Number

59000

Security Products



1



2



3

Part Number

Part Number

- | | | |
|---|---|------------|
| 1 | Blue Security ball | 575006 |
| 2 | Replacement Lock for Avonride Heads (includes 2 keys) | 575000 |
| 3 | Lock for BQ27 Coupling Head (includes 2 keys) | 6X0002.011 |

6X0002.011



Description	Part Number	Reverse	Fog	Reg Plate Lamp
Multipoint V Rear Lamp Cluster LHS	411511.001	✓	✓	✓
Multipoint V Rear Lamp Cluster RHS	411511.002	✓	✓	✓
Earpoint III Rear Lamp Cluster LHS	404485.001	-	✓	-
Earpoint III Rear Lamp Cluster RHS	409012.001	-	✓	-

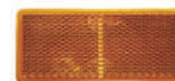

Description	Part Number	Stick On	Screw Fixing	Size (mm)
Reflector Amber Round	4803799X	-	✓	Ø60
Reflector Amber Rectangular	402653.001	✓	-	90 x 40
Reflector White Round	4803819X	-	✓	Ø60
Reflector White Rectangular	402654.001	✓	-	90 x 40
Red Warning Triangle	4803759X	-	✓	157 (x3)



Description	Part Number	Cable	Colour	Size (mm)
Reg Plate Lamp - Large	406650.001	1.5m DC	White	100 x 60
Reg Plate Lamp - Small	406648.001	1.5m DC	White	85 x 49
Superpoint II End Outline Marker LHS	404513.001	0.75m DC	Red/White	170 x 100
Superpoint II End Outline Marker RHS	404514.001	0.75m DC	Red/White	170 x 100
Flexipoint I Position Lamp	406734.001	0.5m DC	White	65 x 44
Flexipoint I Position Lamp	406738.001	1.0m DC	White	65 x 44

L.E.D Lamps

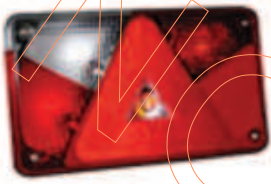

Description	Part Number	Reverse	Fog	Reg Plate Lamp
LED MultiLED II Rear Lamp Cluster LHS	419202.001	✓	✓	✓
LED MultiLED II Rear Lamp Cluster RHS	419203.001	✓	✓	✓
LED EarpointLED Rear Lamp Cluster LHS	418715.001	-	✓	-
LED EarpointLED Rear Lamp Cluster RHS	418716.001	-	✓	-



Description	Part Number	Cable	Colour	Size (mm)
LED Reg Plate Lamp - Large	406649.001	0.8m DC	White	100 x 60
LED Superpoint III End Outline Marker LHS	406808.001	1.0m DC	Red / White	147 x 104
LED Superpoint III End Outline Marker RHS	406809.001	1.0m DC	Red / White	147 x 104
LED FlexipointLED Position Lamp	510357	1.0m DC	White	65 x 44

Description	Part Number	Length	DC Length	13 or 7 Pin
Wiring Harness	510309	3.5m	2 x 3.5m	13 Pin
Wiring Harness	510310	4.5m	2 x 4.5m	13 Pin
Wiring Harness	510311	5.5m	2 x 5.5m	13 Pin
Wiring Harness	510312	6.5m	2 x 6.5m	13 Pin

Description	Part Number
7 Pin to 13 Pin Adaptor (13 Pin Trailer 7 Pin Tow)	405214.001
13 Pin to 7 Pin Adaptor (7 Pin Trailer 13 Pin Tow)	401405.001



13 Pin Wiring Plug View



	Colour	Description
1	Yellow	LH Indicator
2	Blue	Rear Fog Lamp
3	White	Earth for Pins 1 to 8
4	Green	RH Indicator
5	Brown	RH Tail, End Outline, No Plate Lamp
6	Red	Stop Lamps
7	Black	LH Tail, End Outline, No Plate Lamp
8	Pink	Reversing Lamp
9	Orange	12V Power Feed
10	Grey	Fridge (IGN Switched Live)
11	White/Black	Earth for Pin 10
12	White/Blue	Spare (Signal)
13	White/Red	Earth Return for Pin 9

All connections are tubes

12N 7 Pin 12 Volt (Normal) Plug View

	Colour	Description
1 (L)	Yellow	LH Indicator
2 (54G)	Blue	Rear Fog Lamp
3 (31)	White	Earth
4 (R)	Green	RH Indicator
5 (58R)	Brown	RH Tail, End Outline, No Plate Lamp
6 (54)	Red	Stop Lamps
7 (58L)	Black	LH Tail, End Outline, No Plate Lamp



12S 7 Pin 12 Volt (Supplementary) Plug View



	Colour	Description
1 (L)	Yellow	Reversing Lamp
2 (54G)	Blue	Spare
3 (31)	White	Earth
4 (R)	Green	12V Power Feed
5 (58R)	Brown	Spare
6 (54)	Red	Fridge (IGN Switched Live)
7 (58L)	Black	Spare or Earth for Pin 6



Converters are available to enable attachment of 13 pin, 7 pin and 7S connectors for both tow vehicle and trailer.

A 13 pin equipped trailer with reversing lights will need an adaptor when coupled to a 7 pin equipped tow vehicle and reversing lamp will not be functional.

Type approved trailers will need to be equipped with reversing lights:-

O1 optional **** O2 mandatory (one lamp up to 6m long, two lamps over 6m long)

We also supply lighting equipment - see previous pages or contact us for further details



1. Tyre Size Designation

195 = is the nominal section width of the tyre in millimetres.

55 = is described as the aspect ratio, this represents the height of the tyre side wall as a percentage of the nominal section.

R = Radial construction.

10 = stands for the diameter of the wheel that the tyre is designed for in inches.

DOT B6 D0 A S3 X 0304

0304 = Date of Manufacture (week & year)

2. Load Capacity Index

98 = Load index, the maximum weight the tyre can carry at the speed indicated by the speed rating.

N = Speed rating. (see table opposite).

3. M+S = Tyre specifically designed for mud and snow.

Tubeless = Tubeless or tube type (if neither is shown a tube must be fitted).

4. Tyre construction details = Not required in the UK.

5. Country of Manufacture.

6. North American Dept. of Transport markings, Compliance symbol and Identification number.
Not required in UK.

7. European ECE type approval mark and number.
Consisting of approval mark and number

8. Manufacturer and commercial name and identity.

9. Treadwear 400 traction a Temperature A
Uniform tyre quality grading markings, required by USA consumer information regulations - Not required in UK.

Max. load 600kg (1323lbs) Max. press. 350kpa (51 psi)

Max. load / Max. pressure information.

Tyre Speed Symbols

Speed Symbol	Max. car speed for which tyre is suitable km/h	mph
J	100	62
K	110	68
L	120	75
M	130	81
N	140	87
P	150	93

Speed Symbol	Max. car speed for which tyre is suitable km/h	mph
R	170	106
S	180	113
T	190	118
U	200	124
H	210	130
V	240	150

Tyre Load Index

LI	Kg	LI	Kg	LI	Kg	LI	Kg	LI	Kg
70	335	85	515	100	800	115	1215	130	1900
71	345	86	530	101	825	116	1250	131	1950
72	355	87	545	102	850	117	1285	132	2000
73	365	88	560	103	875	118	1320	133	2060
74	375	89	580	104	900	119	1360	134	2120
75	387	90	600	105	925	120	1400	135	2180
76	400	91	615	106	950	121	1450	136	2240
77	412	92	630	107	975	122	1500	137	2300
78	425	93	650	108	1000	123	1550	138	2360
79	437	94	670	109	1030	124	1600	139	2430
80	450	95	690	110	1060	125	1650	140	2500
81	462	96	710	111	1090	126	1700		
82	475	97	730	112	1120	127	1750		
83	487	98	750	113	1150	128	1800		
84	500	99	775	114	1180	129	1850		

LI = Load Index

Kg = Load (Kg)



Since November 2012 tyres sold in the EU have been labelled to enable buyers to make a more informed choice.

An example of this label is shown below with a description of its components.

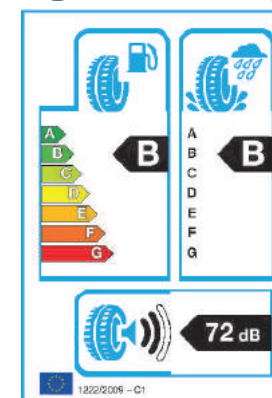

Fuel Efficiency

The energy lost when a tyre is rolling is expressed as a 'rolling resistance'. Lower rolling resistance reduces fuel consumption and CO2 emissions.

Wet Grip

Provides information on the tyre's grip on wet roads, tyres with a higher rating indicate excellent grip and shorter braking distances on wet roads.

Noise Levels

The tyre's exterior noise grading in decibels, one black wave indicates at 3dB below the legal limit, which was made mandatory from November 2016.

We also supply wheels & tyres - contact us for further details



Vehicle
Certification
Agency

We supply certificates, test reports and documentation that can be used for all Type Approved Applications.

Whether you are a volume manufacturer seeking EC Whole Vehicle Type Approval, National Approval or an Individual Approval for a one off trailer, our documentation will satisfy all your needs.



Kraftfahrt-
Bundesamt



ECWTA - 2007 / 46 / EC

European Community Whole Vehicle Type Approval (ECWTA) - 2007/46/EC, GSR 661/2009 for trailers upto 3500kg Gross Weight

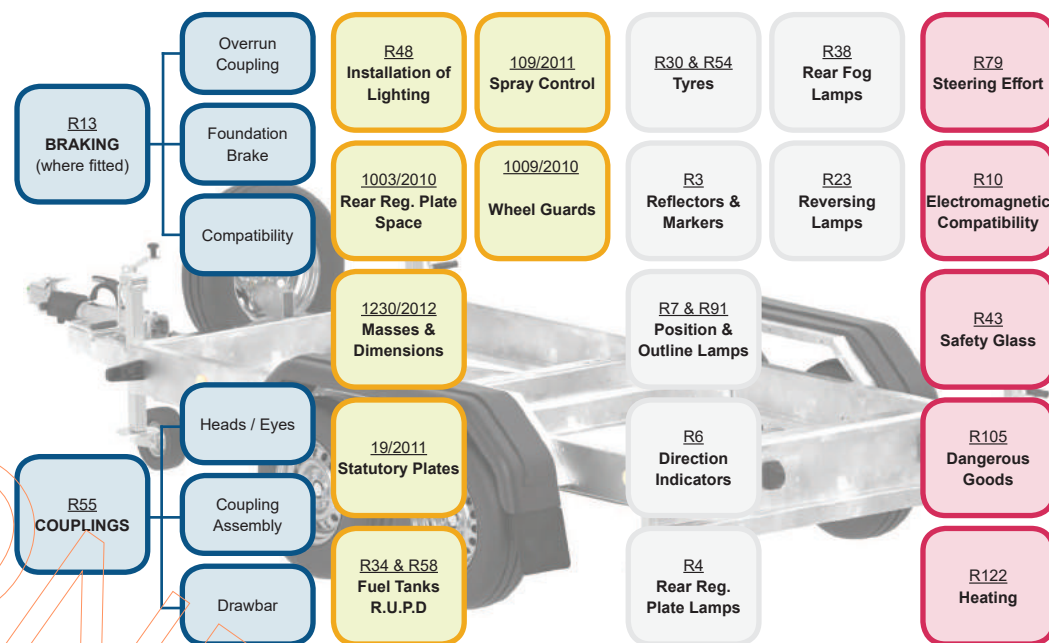

Trailer Weights

Classification	Gross (kg)	Braking
O1	0 - 750	Unbraked with secondary coupling (or optionally braked with breakaway cable)
O2	750 - 3500	Overrun couplings with breakaway cable

NOTE: The maximum mass considered for classifying a trailer corresponds to the static vertical load transmitted to the ground by the axle(s) (Annex II, paragraph 3, 2007/46/EC).

Trailer Dimensions

	Tow Vehicle	Length	Width	Height
The Road Vehicles (Construction & Use) Regulations 1986	< 3500 GVW	7.0m excl. drawbar	2.55m (was 2.3m)	Practical maximum 4.2m
	> 3500 GVW	12.0m excl. drawbar (Min 4 wheels, max combination length 18m)	2.55m	

The information here is intended solely as a guide. It is as accurate as we can make it at the time of printing; however, Knott-Avonride Ltd does not accept any responsibility for any inaccuracies which may be in the text. Any person wishing to depend on the information contained here must check for themselves with the original documentation including any revision or additions to regulations, instruments or the law.

Legal Requirement

The law requires all braked trailers built on or after 1st October 1982 (caravans, horse boxes, flat bed car trailers etc.) to be fitted with a safety device to provide protection in the event of the separation of the main coupling while in motion by applying the trailer brake. This device is described as a 'breakaway cable'.

When fitted to a trailer, its use is **mandatory**.

Purpose of the breakaway cable

The breakaway cable applies the trailer's brakes should the main coupling device become parted from the towing vehicle. If this happens the cable should be able to pull tight, without hindrance, engaging the trailer brakes and is designed to then break, allowing the trailer to come to a halt away from the towing vehicle.

An attachment point shall be incorporated by the towing bracket manufacturer for the attachment of either secondary couplings or devices necessary to enable the trailer to be stopped automatically in the event of separation of the main coupling (as per the requirements of ECE Reg.55 1.6.).

Braked Trailers (Up to 3,500kg GVW).

Either:

Pass the cable through the attachment point and clip it back on itself.

Or

Attach the clip directly to the designated point.

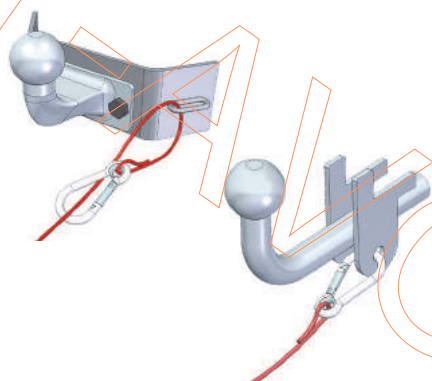

Where a designated attachment point for the cable attachment has not been provided on the towbar, it is suggested that in the case of a fixed towball, the cable be looped around the towball.

For removable type towballs, **always** consult the manufacturer to determine if this method of attachment is acceptable.

Correct procedure for use:

Regularly check the cable and clip for damage, if in doubt, contact your dealer or service agent.

Make sure the cable runs as straight as possible and goes through a cable guide underneath the trailer coupling.

Check to ensure once the cable is attached:

That the cable cannot snag in use on the trailer coupling head, jockey wheel, or any accessory.

That there is sufficient slack in the cable to allow the towing vehicle and trailer to articulate fully without the cable becoming taut and applying the brakes.

That it cannot make contact with the ground; if left loose, the cable may scrape along the ground, damaging it and potentially causing it to fail.

Breakaway cables are designed to function at pre-determined loads depending on the trailer's braking system characteristics. It is important that any replacement complies with the specification of the original cable. (See page 7.).

SECONDARY COUPLINGS (fitted to unbraked trailers)

A 'Secondary Coupling' is a chain or cable that shall be fitted between an unbraked trailer and the towing vehicle and maintains the connection of the two in the event of separation of the primary coupling. This is a legal requirement on trailers manufactured after 1st January 1997.

Coupling Towball Height

Connecting the overrun coupling onto the trailer drawbar or chassis has to be done so that Regulation ECE-R55 is fulfilled concerning the height of the coupling head. That is to say, ECE-R55 Annex 7, paragraph 1.2.1 states: "with the trailer horizontal and carrying the maximum permitted axle load, coupling heads shall be fitted so that the centre line of the spherical area into which the ball fits is 430mm \pm 35mm above the horizontal plane on which the wheels of the trailer rest."

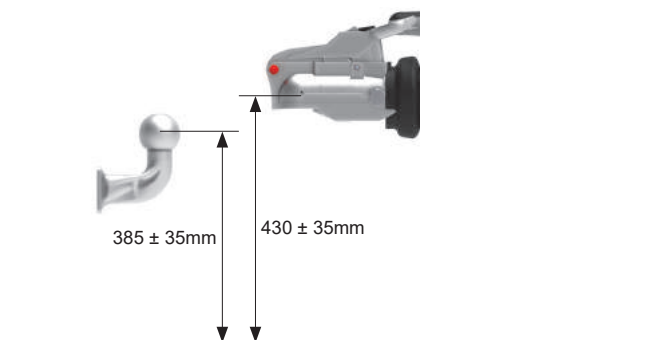

WARNING! There are towballs and hitches from America / New Zealand & Australia in 1 7/8" (47.6 mm), 2" (50.8mm) and 2 5/16" (58.7mm).

These must never be used in conjunction with European 50mm components as the coupling head will either not engage or the ball will be excessively loose inside the coupling head.

Towing Jaws & Hooks

British Standards require that there should be sufficient room behind the pin of any towing jaw to ensure adequate articulation of the eye shaft in both the vertical and horizontal planes.

This also applies to the jaw on a combination jaw and towball unit.

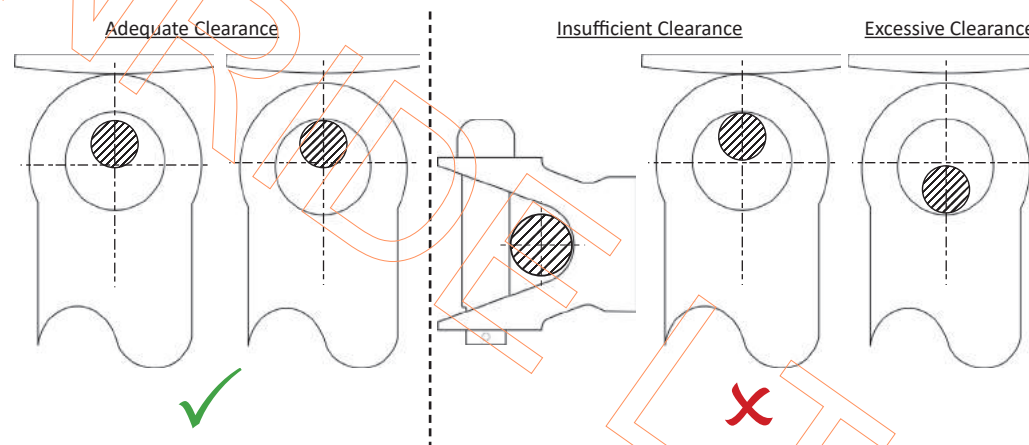

It is also important that this gap is not too great, thus allowing the back of the eye to hit the front of the pin before the front of the eye contacts the throat of the jaw.

DIN and NATO eyes are intended to work with specifically designed tow jaws.

Tow eyes are available in British Standard, DIN (usually DIN40), NATO (usually 76mm) and French (68mm). Knott-Avonride Ltd supply all of these on request including British Standard eyes in 30mm, 40mm and 50mm diameters (see page.2).

Contacts

British Standards Institution.....	www.bsigroup.com
Business Link (select Driving and transport).....	www.businesslink.gov.uk
Department for Transport.....	www.gov.uk
Department of the Environment Northern Ireland.....	www.doeni.gov.uk
Driver & Vehicle Agency Northern Ireland.....	www.nidirect.gov.uk
Driver & Vehicle Standards Agency.....	www.gov.uk
European Tyre & Rim Technical Organisation.....	www.etrto.org
Freight Transport Association.....	www.fta.co.uk
Highways Agency.....	www.gov.uk
Knott-Avonride Ltd, Burton-Upon-Trent, Staffordshire.....	www.knottuk.com
Knott-Avonride Ltd, Maesteg, South Wales.....	www.knottuk.com
Motor Industry Research Association.....	www.horiba-mira.com
National Trailer & Towing Association.....	www.ntta.co.uk
Public Services (including transport).....	www.gov.uk
Road Haulage Association.....	www.rha.uk.net
The European Union on-line.....	www.europa.eu
The Institute of Road Transport Engineers.....	www.soe.org.uk
The Society of Motor Manufacturers and Traders Ltd.....	www.smm.co.uk
United Nations Economic Commission for Europe.....	www.unece.org
Vehicle Certification Agency.....	www.dft.gov.uk/vca/

Knott-Avonride Ltd Publications

KF082	Trailer, Service, Maintenance & Repair Handbook.
KF085	Spreadlever Brakes.
KF087	Oil Damped Energy Store.
KF088	Maintenance & Servicing Information for Coupling Heads, Towing Eyes, Dampers, Propstands, Jockey Bracket, Bowden Cable & Breakaway Cable.
KF089	Maintenance & Servicing Information for Spreadlever Brakes, Hubs & Bearings.
KF097	Maintenance & Servicing Information Operation of Knott Group Coupling Heads & Eyes.
KF098	Maintenance & Servicing Information Guide Bearing Replacement.



Please also visit our website where you will find other publications and further information.

Burton Site

Europa House
Second Ave., Centrum 100
Burton Upon Trent
Staffordshire
DE14 2WF

+44 (0) 1283 531541

+44 (0) 1283 534840

sales@knottuk.com



www.knottuk.com

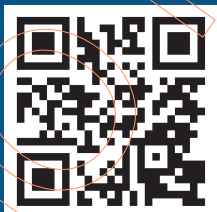

Maesteg Site

Spelter Site
Caerau
Maesteg
Mid Glamorgan
CF34 0AQ

+44 (0) 1656 739111

+44 (0) 1656 737677

maestegsales@knottuk.com



www.knott-trailer.co.uk

